

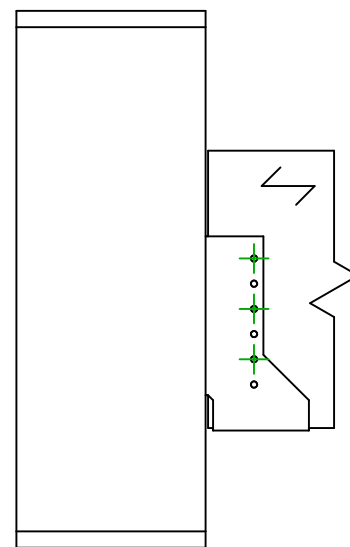

Art. Nr.	=	SAIX380	
Festemidler	=	Tre til Tre	Bjelke på søyle
Type festemiddel	=	Delvis utspikring	

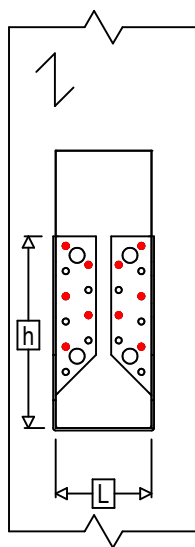

$$h = (380 - L) / 2$$

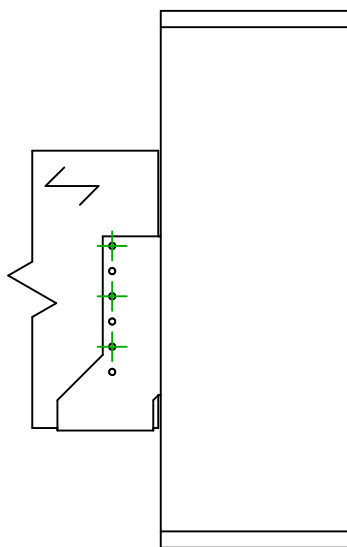
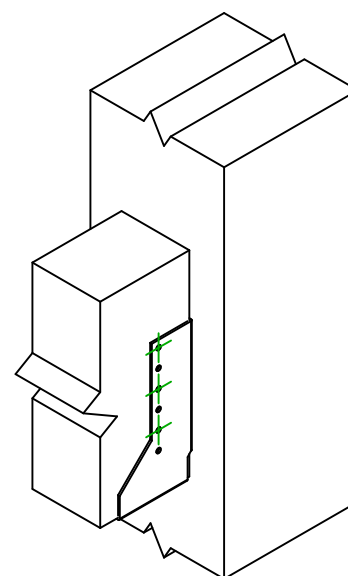

Festemidler i hovedbjelke	Symbol	Festemidler	Festemidler		Antall		
		CNAS		CNA4.0X35S / CNA4.0X50S		10	
CSAS			CSA5.0X35S / CSA5.0X40S				
-		-	-				
Festemidler i sekundærbjelke	Symbol	Festemidler	L < 64mm	L > 64mm	Antall		
		CNAS		CNA4.0X35S		CNA4.0X50S	6
		CSAS		CSA5.0X35S		CSA5.0X40S	