

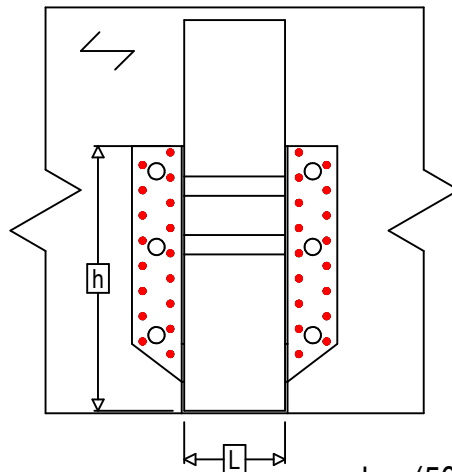

<b>Art. Nr.</b>	=	SAEX500	
<b>Festemidler</b>	=	Tre til Tre	Bjelke til bjelke
<b>Type festemiddel</b>	=	Full utspikring	

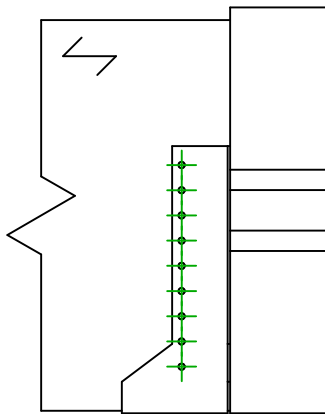

$$h = (500 - L) / 2$$

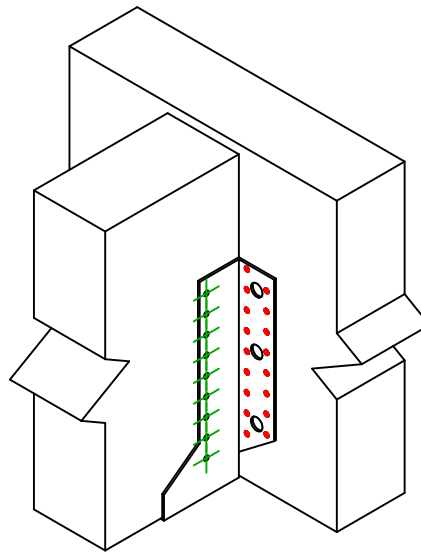
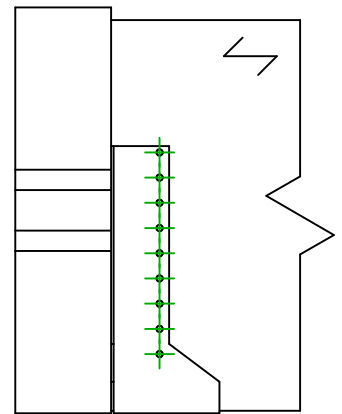

Festemidler i hovedbjelke	Symbol	Festemidler	Festemidler		Antall		
			CNAS	CNA4.0X35S / CNA4.0X50S		34	
		CSAS	CSA5.0X35S / CSA5.0X40S				
		-	-				
Festemidler i sekundærbjelke	Symbol	Festemidler	L < 64mm	L > 64mm	Antall		
			CNAS	CNA4.0X35S		CNA4.0X50S	18
			CSAS	CSA5.0X35S		CSA5.0X40S	